

ANNUAL VEGETATION MANAGEMENT



	January	February	March	April	May	June	July	August	September	October	November	December	
Recording of route vegetation			█										
Coordination with authorities and owners								█					
Implementation maintenance measures (external)	█									█			



Amprion | Integrated Vegetation Management



Photographed by Johannes Döppler

14.06.2023



Photographed by Günther Bayerl

ANNUAL UPDATE OF IVM PLANS





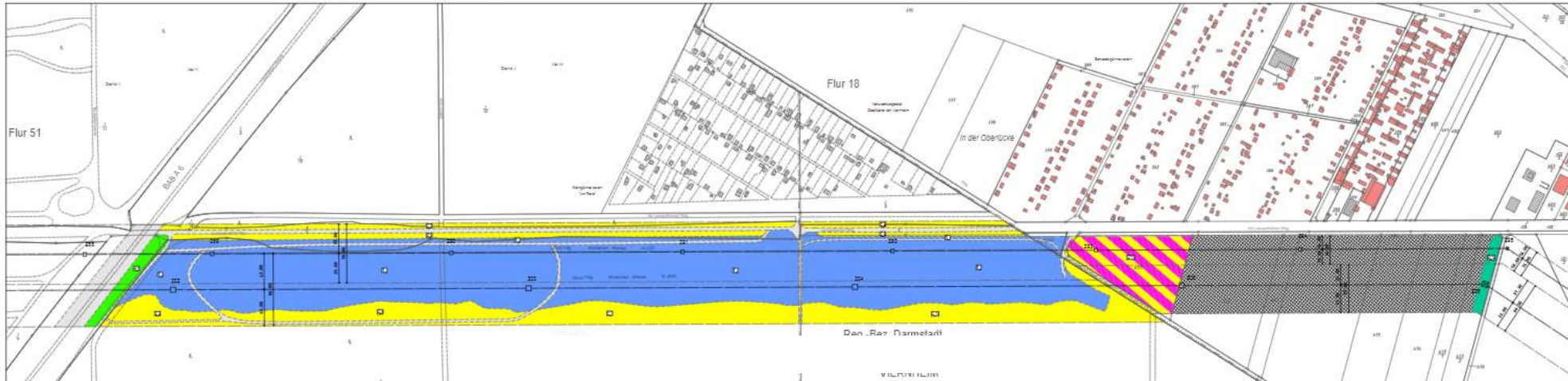

	January	February	March	April	May	June	July	August	September	October	November	December
Project release												
Creation of IVM lists												
Obtain offers and commissioning												
<i>Field mapping (external)</i>												
<i>Digitisation (external)</i>												
<i>Checking condition of route vegetation (external)</i>												

Processing only possible after the end of the maintenance measures

IVM PLAN

Digitisation in a geographic information system

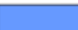

-Nr		Maßnahme/Pflegeeinheit (siehe Textteil)	Detail - Informationen				
			Typ	Nr.	Fläche (qm)	Pflege (%/St.)	Aufarbeitungsform
C		Einzelentnahme von leitungsfähigem Aufwuchs, selektive Vorwuchsentnahme (kleinflächig) nach Bedarf	C	2	4863,3		
CY		Einzelentnahme von leitungsfähigem Aufwuchs auf einer Siedlungsfläche	C	3	4782,8		
D		"Auf den Stock setzen" von Teilflächen im 2-4-Jahres-Turnus	C	5	2260,9		
H		Entbuschen im 4-7-Jahres-Turnus	C	6	5547,0		
T		Beweidung nach Bedarf	C	7	9411,9		
V		Landwirtschaftliche Nutzfläche (Acker, Wiese, Weide, Dauerkultur)	C	8	1846,0		
Z		Weg, Bahnlinie, u.ä. Verkehrswege	C	9	1301,4		
			C	10	10186,9		40200,2 m ²
			CY	11	8573,0		8573,0 m ²
			D	12	1196,8		1196,8 m ²
			H	1	1944,7		1944,7 m ²
			T	4	83861,8		83861,8 m ²